

# CERTIFICATE OF LOCATION OF GOVERNMENT CORNER

NORTHEAST Corner of Section 25, Township 108, Range 41, 5TH P.M.

STATE OF MINNESOTA, County of MURRAY

At the corner location shown on the sketch:

- On \_\_\_\_\_ found a \_\_\_\_\_
- left monument as found,  lowered monument,  removed monument (explain)
- On 4/30/14 placed a 1" pipe w/seal #43844

SKETCH OF REFERENCE TIES

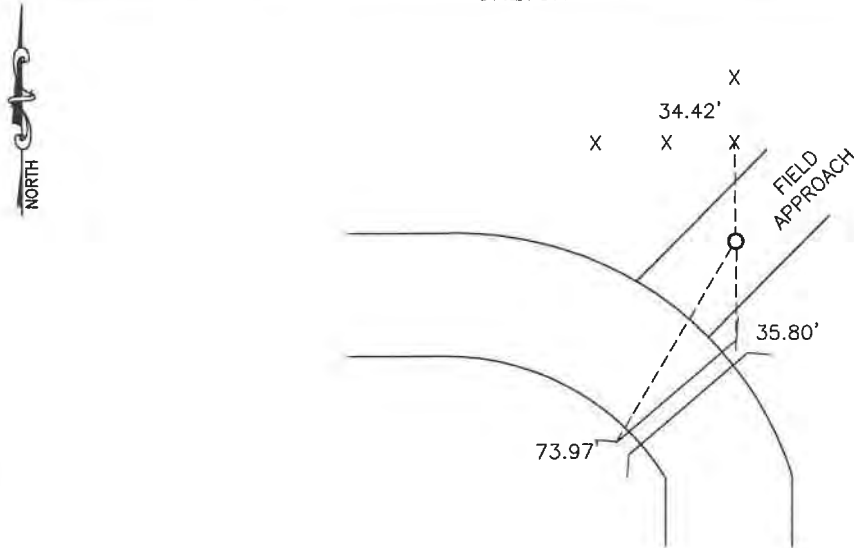

Minnesota State Plane Coordinate System Murray County Datum NAD83 (1996)  
 N: 205735.934  
 E: 516613.283

Nail and survey marker in corner fence post North 34.42'  
 Recorded ties from 1972 survey:  
 Punch hole on top of CMP SSW 35.80'  
 Rivet on top of CMP SSW 73.97'

Statement of evidence relative to this corner location is on back of page.

I hereby certify that this document and the data contained herein was prepared by me or under my direct supervision.

[Signature] Jan. 7, 2020  
 SIGNATURE DATE

Registration No. 43844  
 Land Surveyor,  Professional Engineer  
 County Surveyor,  County Engineer

OFFICE OF THE COUNTY RECORDER

County of \_\_\_\_\_

I hereby certify that this document was filed in the Co. Recorders office at 10:00 A.M on the 8<sup>TH</sup> day of JANUARY A.D. 20 20

County Recorder Cuelyn C. Larson

By \_\_\_\_\_, Deputy

DOCUMENT NO. \_\_\_\_\_

## Statement of Evidence

In 1861, J. W. Myers did the original survey of the west line of the township.

In 1913, a stone was recorded at the corner.

On September 26, 1972, a stone was found at the corner and ties recorded.

On April 30, 2014, Bueltel-Moseng Land Surveying dug by hand, probed a large area and found nothing. Set 1" pipe with seal #43844 using recorded ties from 1972 survey. It is in centerline of road to the south.